

## Swift Burnisher prt#.2W22101 Assembly page 5.

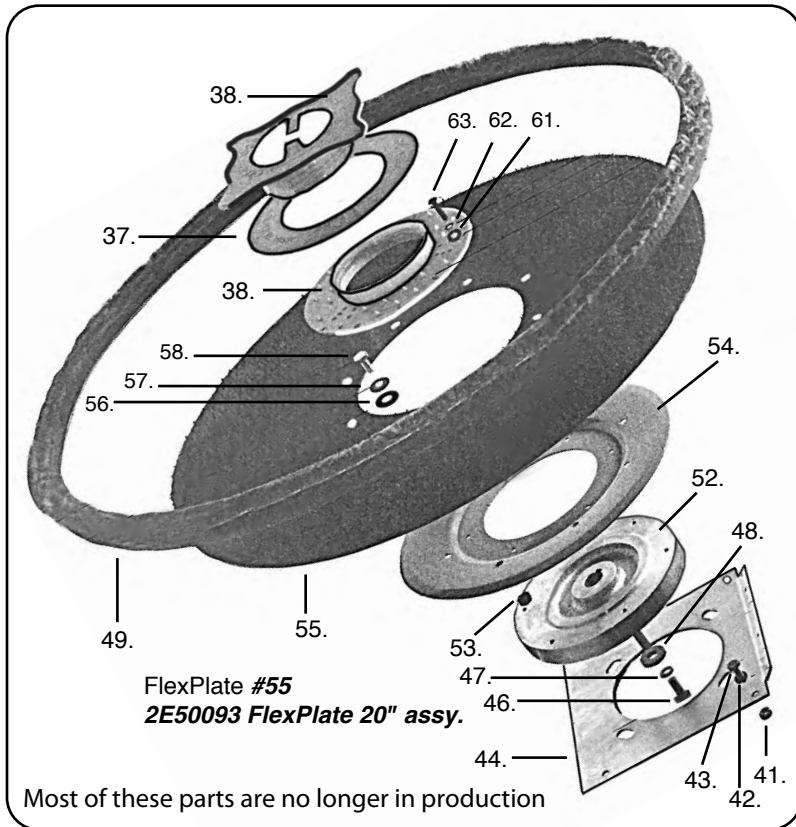

- 41. 6D02805 Nut 1/4" grd 8
- 42. 6K02203 Lock Washer
- 43. 6A30700 Mach.screw 1/4"
- 44. 2E50300 Motor plate (page 3)
- 46. 6A37500 Mach.screw 5/16"
- 47. 6K02301 Lock washer 5/16"
- 48. 6K02407 Washer 1-3/8" (thick)
- 49. 2E50020 Dust seal
- 52. 2E50060 Disk drive hub

55. sold as 2E50093 FlexPlate assy  
 & consist of

- a. 6D02803 Nut, keps 1/4
- b. 54. 2E50092 Adaptor plate
- c. 55. 2E50091 20" Flexible plate
- d. 58 6A30400 Mach.scr. 1/4-1/2 hex h.
- e. 57 6L00600 Disc spring 18odx6.2x0.7mm
- d. 56 6K02209 Nylon Washer, shoulder 1/4

- 61. 6K02000 Washer flat #10
- 62. 6K02006 Washer, lock
- 63. 6A19303 Mach.scr. #10

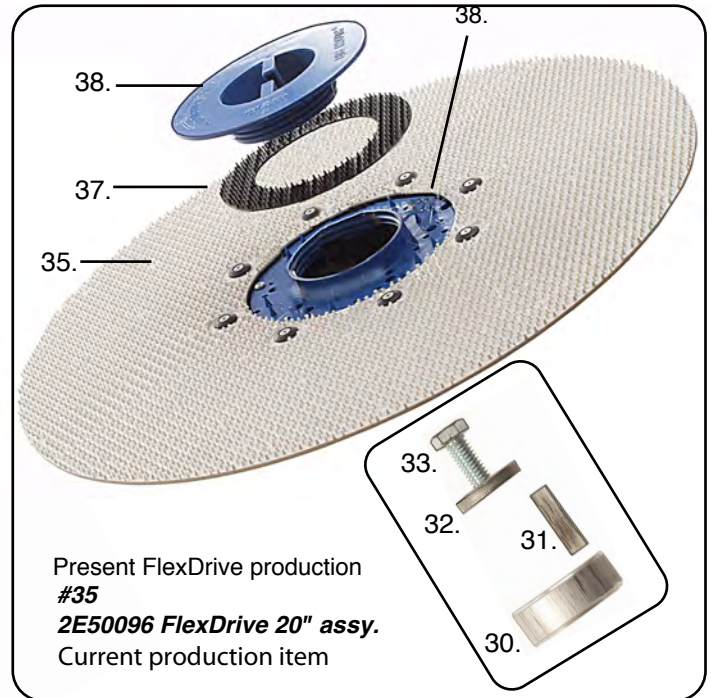

35. sold as 2E50096 FlexDrive 20" assy.  
 & consist of:

- 35. 9M50096 Flex drive
- 37. 2A80204 Thin washer
- 38. 2A80215 Center-lock assy.  
 (Center-lock screw & its base sold as a pair)

- 30. 2E50098 Spacer
- 31. 7A96001 Sq. Key
- 32. 6K02407 Washer 1-3/8"
- 33. 6A37500 Mach.screw 5/16"

