

## Rabbit & Swift Motor parts. (Rectified DC, Permanent magnet type)

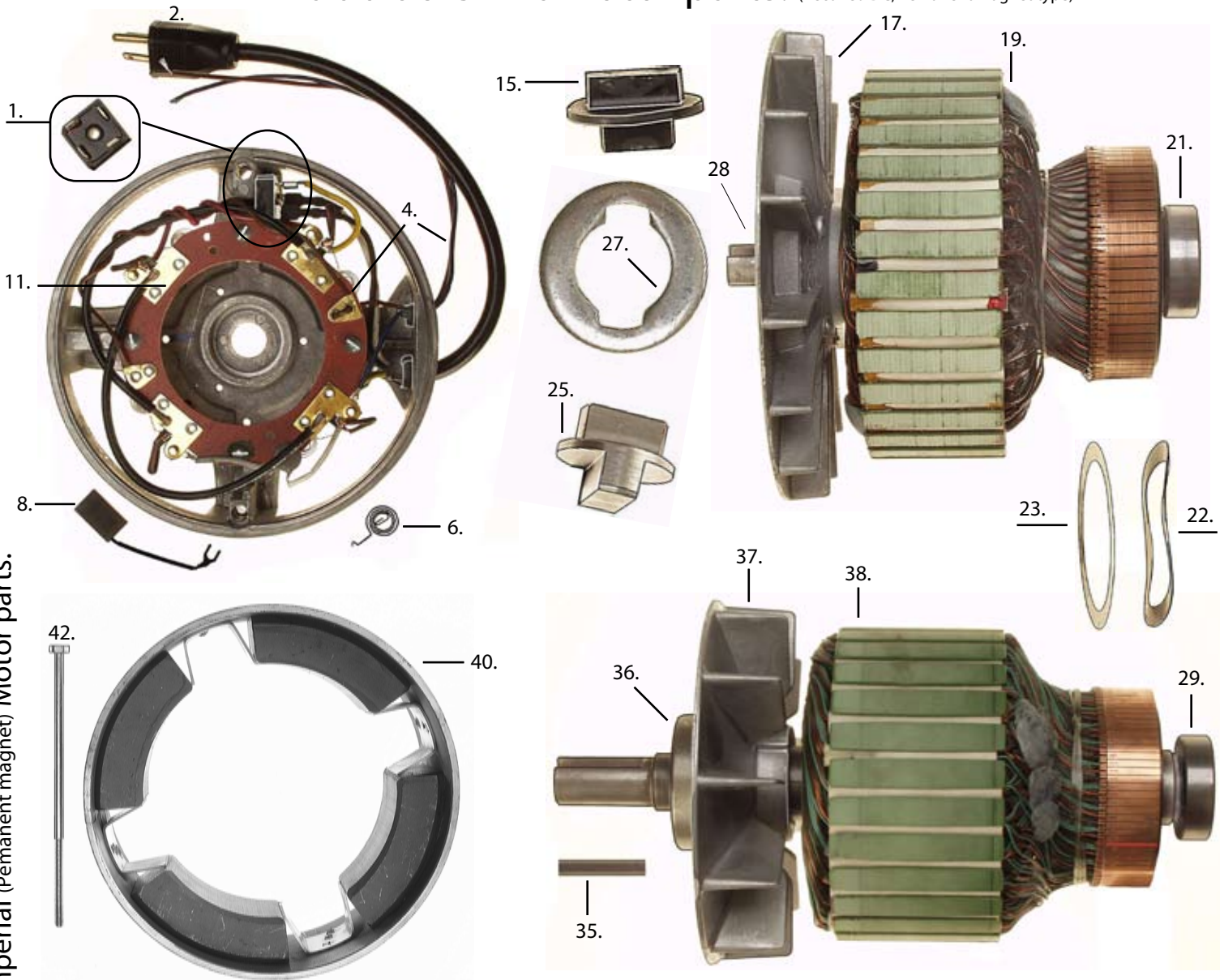

Imperial (Permanent magnet) Motor parts.

- 1. 7A95820 Rectifier kit 120volt
- 7A95821 Rectifier kit (220volt)
- 7A95805 Rectifier 120v 60Amp
- 7A95806 Rectifier (220v 60Amp)
- 2. 7C54504 Motor cable 56 frame Swift
- 7C54506 Motor cable 66 frame Rabbit
- 4. 7A95804 Brush wear indicator
- 6. 7A95803 Spring
- 8. 7A95801 Carbon brush 120volt
- 8. 7A95810 Carbon brush (220volt)
- 11. 7A95802 Brush board 56 frame
- 7A95804 Brush board 66 frame
- 15. 2B96004 Coupler, rubberized
- 17. 7A96510 Fan 66frame
- 19. 7A96508 Rab-3 armature, 3200rpm 66frm 120v
- 7A95808 Rab-2 armature, 3200rpm 56frm 120v
- 7A96608 Rab-6 armature, 1500rpm 66frm 120v
- 7A96308 Rab-3 armature, 2000rpm 56frm 120v
- 7A96408 Rab-3 armature, 2000rpm 56frm (220v)

- 21. 9V10100 Bearing
- 22. 7A95812 Helical washer
- 23. 6K01705 Spacer washer
- 25. 2B96003 Coupler, steel  
(this coupler was used on Rabbit-6)
- 27. 2B96326 Collar
- 28. 9V10200 Bearing
- 29. 9V10100 Bearing
- 31. 2B96006 Coupler, steel  
(used on Rabbit-6, Woodpecker & Stonechat starting 2002-04)
- 32. 6A10900 Screw
- 35. 7A96001 Key
- 36. 9V10500 Bearing
- 37. 7A95811 Fan 56frame
- 38. 7A96008 Swift armature 120v
- 7A96108 Swift armature (220v)
- 40. 7A95809 Field with magnets 56frame
- 42. 6A32900 Machine screw

