

## Handle Tube Assembly **GALAXY** Rabbit-2 Part #2E90035

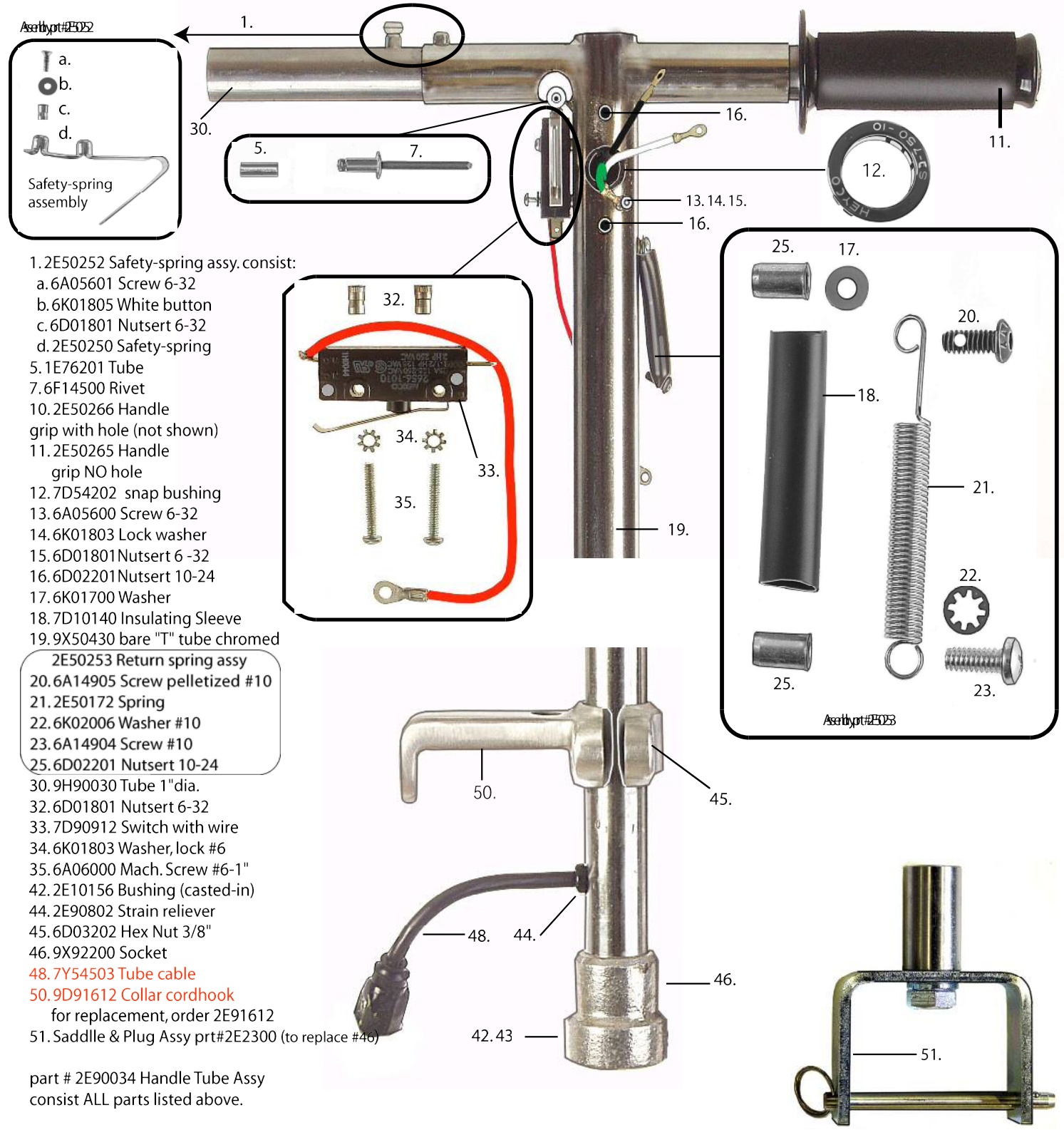

1. 2E50252 Safety-spring assy. consist:

- a. 6A05601 Screw 6-32
- b. 6K01805 White button
- c. 6D01801 Nutsert 6-32
- d. 2E50250 Safety-spring
- 5. 1E76201 Tube
- 7. 6F14500 Rivet
- 10. 2E50266 Handle grip with hole (not shown)
- 11. 2E50265 Handle grip NO hole
- 12. 7D54202 snap bushing
- 13. 6A05600 Screw 6-32
- 14. 6K01803 Lock washer
- 15. 6D01801 Nutsert 6-32
- 16. 6D02201 Nutsert 10-24
- 17. 6K01700 Washer
- 18. 7D10140 Insulating Sleeve
- 19. 9X50430 bare "T" tube chromed

- 2E50253 Return spring assy
- 20. 6A14905 Screw pelletized #10
  - 21. 2E50172 Spring
  - 22. 6K02006 Washer #10
  - 23. 6A14904 Screw #10
  - 25. 6D02201 Nutsert 10-24

- 30. 9H90030 Tube 1" dia.
- 32. 6D01801 Nutsert 6-32
- 33. 7D90912 Switch with wire
- 34. 6K01803 Washer, lock #6
- 35. 6A06000 Mach. Screw #6-1"
- 42. 2E10156 Bushing (casted-in)
- 44. 2E90802 Strain reliever
- 45. 6D03202 Hex Nut 3/8"
- 46. 9X92200 Socket
- 48. 7Y54503 Tube cable
- 50. 9D91612 Collar cordhook  
for replacement, order 2E91612
- 51. Saddle & Plug Assy prt#2E2300 (to replace #46)

part # 2E90034 Handle Tube Assy consist ALL parts listed above.

not included in the above list & sold separately are:  
 43. 2E10155 Bushing repair Kit  
 47. 7D11292 Plugs, male & female, water proof typ  
 19. 9X90034 Tube+socket+cordhook not saleable by itself.

Learn how to replace #46 with #51 go to  
[http://centaurmachines.com/wp/wp-content/uploads/2011/08/how\\_to\\_replace\\_socket\\_with\\_the\\_saddle.pdf](http://centaurmachines.com/wp/wp-content/uploads/2011/08/how_to_replace_socket_with_the_saddle.pdf)